

Tasks for the exam "Module Mental Health"
(for discussion with students)

Problem # 1. Relatives of patient A., 53 years old, began to hear her complain about a sharp decline in mood, especially in the morning. A. complained of oppressive melancholy, a feeling of hopelessness, and an unwillingness to live. She believes that the reason for this feeling is that she “lived her life in vain, did nothing worthwhile,” and “was always a burden to everyone.” She considers herself a worthless person, unworthy of life. She also notes that everything around her has ceased to please, food has become tasteless, colors are dull, “as if everything is covered with a veil.” She complained of a feeling of heaviness behind the breastbone, “as if a stone had been placed on it.” During a conversation with the doctor, her speech is slow, she answers after long pauses. Her facial expression is mournful. Her movements are also slow, and she spent most of her time at home in bed. She admitted to the doctor that she would perceive death with relief.

What disease symptoms are described in this example?

Problem # 2. Patient V. (49 years old), suffering from hypertension, emphasizes in every way his similarity to healthy people. He ignores some manifestations of his disease (for example, headaches) completely. He readily discusses other patients, exaggerating and emphasizing their inadequacy in comparison with himself (“I am not like other patients, I am almost healthy”).

What kind of attitude behavior does the patient demonstrate? Possible difficulties in managing such a patient, the doctor's behavior tactics.

Problem # 3. During the examination of the patient of the psychiatric hospital Yuri T. (29 years old), the following features of mental activity were revealed:

- lack of criticality towards one’s own behavior and painful symptoms with formal access to basic intellectual operations and sufficient productivity of auditory-verbal memory;
- pronounced disturbances of the motivational component of thinking with episodes of lack of purpose, diversity of judgments and distortion of the generalization process;
- pretentiousness of speech, detailed reasoning with an abundance of statements of hyper-abstract content.

What mental sphere disorders – processes/properties/states – are observed in the patient? What symptom complex are these disorders characteristic of and what mental disorders does it occur with?

Task # 4. Here is a fragment of a description of a pathopsychological study:

When presented with a task to classify objects, the patient cannot comprehend the instructions for a long time and spends a long time looking at the cards. She picks up a picture of a goose and says: "There is no other like it here, this is a gander, there are no other geese" (puts the card aside). She picks up a card with a picture of a carrot: "This is a carrot... Look at you, how beautiful, there are no others like it." The experimenter suggests putting the carrot in one group with the beetroot, the patient protests: "That is a carrot, and this is a beetroot; they are different." After thinking, she continues: "You can make borscht from them, put cabbage in there." She looks for a card with cabbage: "It is not there." The experimenter repeats the instructions again, suggesting combining the suitable objects in one group. The patient puts a cow with a goat, saying: "They graze together." The experimenter suggests putting a bear there, the patient

frightenedly objects: "What are you saying, he'll eat her." The patient accepts the experimenter's suggestion to put the blacksmith and the cleaning lady into one group: "Let them be, they're husband and wife, but where are the kids?" She searches among the cards, finds a skier: "That's their son."

What mental sphere disorders – processes/properties/states – are observed in the patient? What symptom complex are these disorders characteristic of and in what mental disorders does it occur?

Task #. 5. The patient is asked to perform the following motor program: "When I hit the table once, you raise your right hand, when I hit it twice, you raise your left hand." The patient can repeat the instruction, but its implementation is grossly distorted. Even if the initial execution is adequate, then when repeating the sequence of stimulus hits (I-II; I-II; I-II), the patient develops a stereotype of hand movements (right - left, right - left, right - left). When the sequence of stimuli changes, the patient continues to perform the stereotyped sequence that has developed in him, not paying attention to the change in the stimulus situation.

What neuropsychological disorder are we talking about and in what mental disorders does it occur?

Problem # 6 Patient S., 53 years old, was referred to a psychologist, complaining of general malaise, periodic headaches, and increased fatigue. There is no anamnestic information about local brain damage or use of psychoactive substances. After conducting diagnostics, the psychologist noted that S. has decreased productivity of immediate memorization and the speed of changing attention from one topic to another.

What mental sphere disorders – processes/properties/states – are observed in the patient? What symptom complex are these disorders characteristic of and in what mental disorders does it occur?

Problem # 7. A neuropsychologist has identified the following features of the patient's motor sphere. Movements lack fine differentiation, which is clearly evident when reproducing the pose of the fingers of a hand according to a given pattern, as well as when transferring the pose from one hand to another (without visual control). The described disorders concern both the right and left hands.

What neuropsychological disorder are we talking about and in what mental disorders does it occur?

Problem # 8. Client D., 35, came to see a psychologist. A year and a half ago, D. experienced a serious conflict with colleagues, which seriously disrupted his career plans and damaged D.'s professional reputation. Since then, D. has had a feeling of inferiority. The client came to see a psychologist because he wanted to understand himself and whether D. was a "normal person."

What mental sphere disorders – processes/properties/states – are observed in the patient? In what mental illnesses can these disorders be observed?

Problem # 9. Patient L. (40 years old) was repeatedly hospitalized in a neurological clinic for protracted radiculitis with severe pain syndrome and impaired sensitivity. During group therapy in a psychotherapeutic group, it was possible to find out that he served in Afghanistan,

slowly moved up the career ladder for many years, tolerated the tyranny of his boss and for many years did not allow himself to express emotions of fear and anger. Faced with a situation that disturbed him during a session, he did not want to get up after finishing playing out his dream (functional paralysis occurred) and groaned. Using the technique of verbal reflection and amplification of his sounds, it was possible to make the man scream: he had been suppressing the emotion of fear in the unconscious for many years.

Describe the patient's condition in terms of the illness behaviour

Task #10. When completing the "Classification of Objects" task, the subject groups furniture items into one group, and also places an inkwell ("it's on the table") and a book ("since the bookcase is here, the book should be here"). He cannot identify a group of measuring instruments ("I don't know what they do with this"). He cannot cope with the last stage of classifying objects, and does not understand how animals and people can be grouped together.

What mental sphere disorders – processes/properties/states – are observed in the patient? What symptom complex are these disorders characteristic of and in what mental disorders do they occur?

Problem # 11. During a terrorist attack in the subway, students from a nearby school became direct witnesses of the events. They saw destroyed walls, crippled people, and rescuers working. The school principal asked psychologists to come to the school and help the children cope with the situation. The children asked many questions about the events, cried, and said that they were afraid to ride the subway.

What mental illness can be observed in this example? Describe the possible consequences of this condition.

Problem #12: A patient in a mental hospital, upon admission, made the following statement to the staff: "You look like smart, lively, hard-working, honest, energetic guys, and I can use you in my enterprise! I need reliable guys who don't want to miss the great opportunities that life on this planet offers! It's all in your hands! Too many people pass their chance by without hearing it knocking at the door, because they don't know how to seize the moment and start striking while the iron is hot! You must seize it when it appears on the surface, get hold of the ball and run! You must be determined! Determined! Determined! No hesitation! Sweat! Yes, sweat for your goal! Forward, forward, forward and you will move a mountain! Or two mountains! It's not a matter of luck! Hell, if it weren't for misfortune, I wouldn't see any luck! Be the very first of the very best!"

What mental sphere disorders – processes/properties/states – are observed in the patient? In what mental illnesses can these disorders be observed?

Problem # 13. Patient Sh. (45 years old) has been suffering from gastritis for many years. She is characterized by a focus on painful sensations, a desire to constantly describe her suffering to others, exaggerating the real and looking for non-existent details of the disease. Sh. experiences contradictory feelings: she wants to be treated, requires thorough examinations and uses the prescribed drugs, but at the same time expresses doubts about the success of the treatment, is afraid of painful examinations and side effects of drugs. Sh. experiences noticeable relief if the

interlocutor treats her with sympathy and compassion. A negative reaction is caused by mistrust of complaints from others, their reproaches for exaggerating the severity of the disorder.

What type of illness behaviour are we talking about? Describe this type.

Problem # 14. Patient P. (68 years old) is visiting a neurologist. Without any apparent reason, P. developed severe memory impairments for current events, amnesic disorientation, and confusion. Later, handwriting, spatial orientation, and body scheme impairments were added. At the time of examination, P.'s speech is grossly perseverative, muscle rigidity, stiffness, and Parkinsonian manifestations are observed.

What disease are we talking about?

Task # 15. Read the conclusion fragment and determine what psychopathological syndrome it contains. What diseases does it occur with? Justify your answer.

The patient complains of changes in the perception of his own body. For example, it seems to him that his arms and legs are larger, swollen and in constant motion.

Task # 16. Read the conclusion fragment and determine what psychopathological syndrome is in it. In what diseases does it occur? Justify your answer.

A patient, being in a psychiatric hospital for ten days, claims that he has never seen his bed and cup, describes them as new and unfamiliar. He responds to the assurances of the medical staff with distrust, insists on his position.

Task # 17. Read the fragment of the conclusion and determine what psychopathological syndrome is in it. Describe this syndrome.

After using drugs, the patient began to see vivid images of non-existent animals. The animals looked distinct, their images were perceived as real, embedded in the situation.

Problem # 18.

During the experimental pathopsychological study, the patient learns the instructions well and follows them. At the beginning of the study, he copes well with the implementation of the methods, does not make mistakes. However, after a short time, he complains of fatigue, becomes fussy, irritable, begins to make gross errors when performing the methods aimed at studying attention, memory, thinking, regardless of their level of complexity.

What mental sphere disorders – processes/properties/states – are observed in the patient? What symptom complex are these disorders characteristic of and what diseases do they occur with?

Problem # 19.

The patient, performing methods aimed at studying attention and memory (proofreading test and 10 words), initially performs them well, then the quality of performance deteriorates, but at the next stage it improves again. In general, the memorization curve is zigzagging.

What mental sphere disorders – processes/properties/states – are observed in the patient? What symptom complex are these disorders characteristic of and what diseases do they occur with?

Task # 20. Read the fragment of the pathopsychological conclusion and determine what pathopsychological symptom is in it. Justify your answer.

In the process of performing the method of memorizing 10 words, the patient memorizes 7 words after the first presentation. In subsequent presentations, he shows a similar result.

Task # 21. Read the fragment of the pathopsychological conclusion.

During the conversation, the patient, answering the psychologist's questions, goes into lengthy discussions about the meaning of individual words heard from the psychologist, as well as about the words pronounced by the patient himself. He becomes wise, indulges in reasoning. The statements are florid and pretentious.

What mental sphere disorders – processes/properties/states – are observed in the patient? What symptom complex are these disorders characteristic of and what diseases do they occur with?

Problem # 22. Please see an part from the pathopsychological report .

When performing methods aimed at studying the characteristics of thinking, the patient is unable to choose one basis for combining methods into one group, claims that all the methods of combining objects that he has given are equally justified, and claims that it is impossible to choose one of them as the most correct, generalized by an essential feature.

Problem #23. Please read the part from the pathopsychological report.

During the experimental psychological study, the patient performs tasks mainly at the concrete-situational level of generalization; the functional level of generalization is partially accessible, while generalizations at the categorical level are practically absent.

Task #24. Read the fragment of the pathopsychological conclusion.

The patient, performing the methods “Exclusion of the concept”, “Classification”, combines concepts and pictures correctly, and when asked by the psychologist about the basis for combining these concepts or pictures into one group, selects common features, sometimes purely external similarities between objects and concepts.

What area is being investigated? Are there any mental disorders in this example?

Task # 25. Read the fragment of the pathopsychological conclusion and determine what pathopsychological symptom is in it. In what disorders does it occur?

The patient, performing tests on thinking, alternates adequate and inadequate answers in his answers, while no gross disturbances of thinking are observed. The productivity of thinking is generally unstable.

Task # 26. Read the fragment of the pathopsychological conclusion and determine what pathopsychological symptom is in it. In what mental disorders does it occur ?

During the experimental psychological study, the subject exhibits viscosity, stiffness of thinking, difficulty changing settings when performing individual tasks. The subject complains that nothing comes to mind for a long time.

Task #27. Read the part of the pathopsychological conclusion and determine what pathopsychological symptom is in it. In what diseases can it occur ?

When performing the pictogram technique, the patient mainly uses images related to the performance of individual actions. For the phrase "hard work" he draws a man with a shovel, explaining that a shovel is needed to perform hard work, for example, digging a hole.

Task # 28. Read the part of the pathopsychological conclusion and determine what pathopsychological symptom is in it. In what diseases can it occur?

The patient complains that he has thoughts that he cannot get rid of. The thoughts are of an anxious nature, associated with the anticipation of unpleasant consequences from what he has done. To combat these thoughts, the patient uses rituals. If the ritual cannot be performed, the anxiety increases.

Problem # 29. Read the conclusion fragment and determine what psychopathological syndrome is in it. Describe this psychopathological syndrome.

After prolonged alcohol abuse, the patient began to see small insects crawling all over his body in the morning. These images were accompanied by corresponding sensations in his limbs and throughout his body.

Problem # 30. Read the fragment of the conclusion and determine what psychopathological syndrome is in it . In what diseases can it occur?

The patient was admitted to a psychiatric hospital after experiencing intoxication. After some time, the patient exhibited behavior that outwardly resembled behavior in a state of mild alcohol intoxication, his attention was somewhat scattered, and he had difficulty collecting his thoughts. Due to the slowness of perception, some answers were given seemingly out of place.

Problem # 31. Read the conclusion fragment and determine what psychopathological syndrome is in it. Describe this syndrome. In what diseases can it occur?

The patient involuntarily has fantastic dream-like ideas in the form of complete images in their content, which follow in a certain sequence. It seems to the patient that he is making an interplanetary journey.

Problem # 32. Read the conclusion fragment and determine what psychopathological syndrome is in it. Justify your answer.

Patient G., having left the house, after some time discovered that he was in another part of the city. According to eyewitnesses, the patient seemed to be absorbed in himself, and performed actions automatically.

Task # 33. Read the conclusion fragment.

In the personal sphere, the patient is characterized by increased anxiety, pedantry, and is inclined to double-check his own actions. He is inclined to form protective behavioral rituals to reduce the level of anxiety.

What disorder is described in this example?

Task # 34. Read the conclusion fragment.

The patient's personality is characterized by the presence of rigidity of affects, vindictiveness, and a tendency to accumulate negative affect with subsequent external reactions.

What personality type does this description match?

Problem # 35. Please read the excerpt from the conclusion.

The patient is characterized by a tendency to constantly seek thrills, hedonistic pleasures, and idle pastimes. He does not declare long-term goals and is frivolous when discussing them. He has repeatedly used narcotic substances.

What personality type does this description match?

Task #36. Read the conclusion fragment.

The patient complains of increased fatigue and irritability. Fatigue is more pronounced under high intellectual load. Aggressive reactions are short-lived and neurasthenic in nature. Presents numerous complaints about the state of health.

What mental disorder does this description correspond to and what are the causes of this condition?

Problem # 37. Please read the excerpt from the conclusion.

In the personal sphere, the patient is distinguished by isolation, detachment, a tendency to solitude, and uncommunicativeness. He prefers to engage in activities that do not require interaction with others. He says that since childhood he preferred to play alone.

What personality type does this description match?

Task # 38. Check out the results of the “Classification of Objects” method Identify the main pathopsychological symptoms of impaired thinking. Suggest the leading pathopsychological syndrome, in what diseases can it occur?

At the first stage, the patient brings together the doctor, the child and the thermometer, explaining that the doctor treats the child based on the temperature indicated on the thermometer.

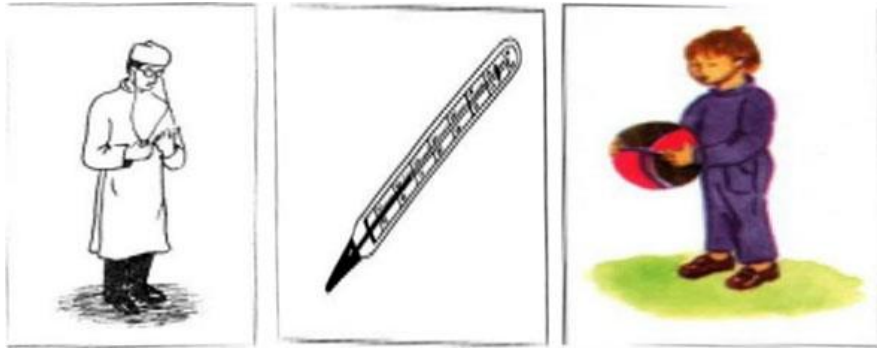

Task # 39. Review the results of the “Classification of Objects” method. Determine the main pathopsychological symptoms of thinking disorders. Suggest the leading pathopsychological syndrome. In what diseases can it occur?

At the first stage, the patient combines a closet, a cart and a bicycle, explaining that the cart rolls and the bicycle rolls, you can put things in the closet and in the cart. The cart combines them. It is ideal.



Task # 40. Check out the results of the “Exclusion of Objects” technique Identify the main pathopsychological symptoms of thinking disorder. Suggest the leading pathopsychological syndrome and justify the answer.

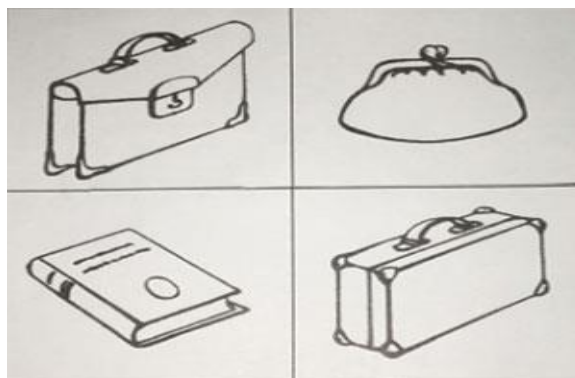

Excludes the book, and the rest is storage facilities.

Task # 41. Check out the results of the “Exclusion of Objects” technique. Identify the main pathopsychological symptoms of impaired thinking. Suggest the leading pathopsychological syndrome and what diseases can it occur with?

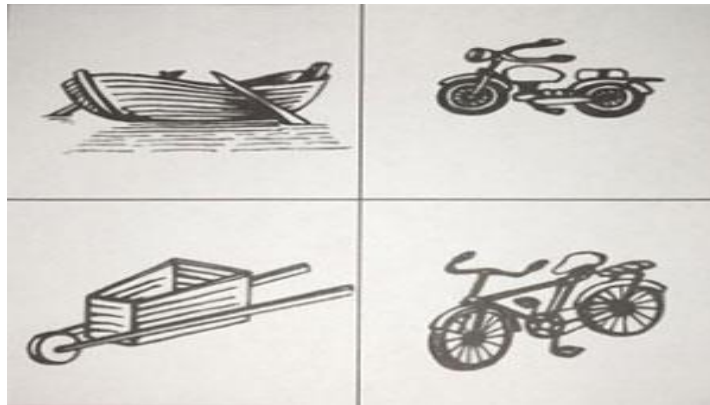

The odd one out is the boat, and the rest has a wheel.

Task # 42. Check out the results of the “Exclusion of Objects” technique Identify the main pathopsychological symptoms of thinking disorder. Suggest the leading pathopsychological syndrome and justify your answer.

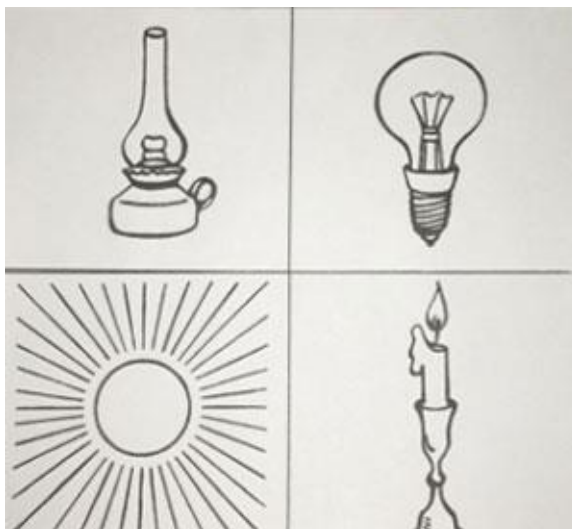

The excess is the sun, and the rest are artificial light sources.

Task # 43. Check out the results of the “Exclusion of Objects” technique Identify the main pathopsychological symptoms of impaired thinking. Suggest the leading pathopsychological syndrome and *what diseases can it occur with?*

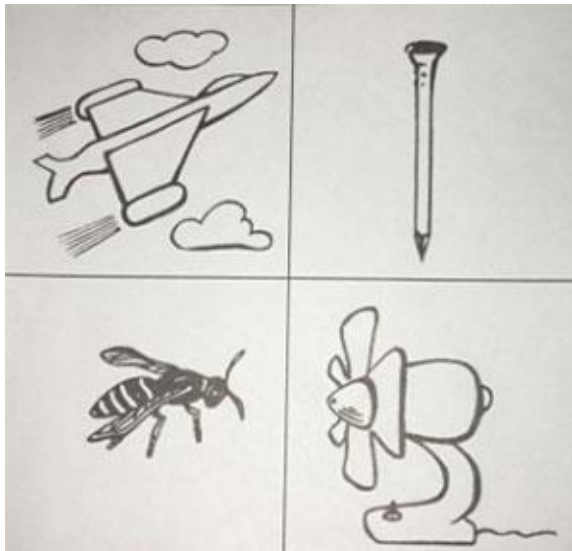

The odd one out is a nail. An airplane makes a hum, a bee buzzes, an air conditioner makes a buzzing noise, but a nail does not.

Task # 44. Check out the results of the “Exclusion of Objects” technique Identify the main pathopsychological symptoms of impaired thinking. Suggest the leading pathopsychological syndrome and *what diseases can it occur with?*

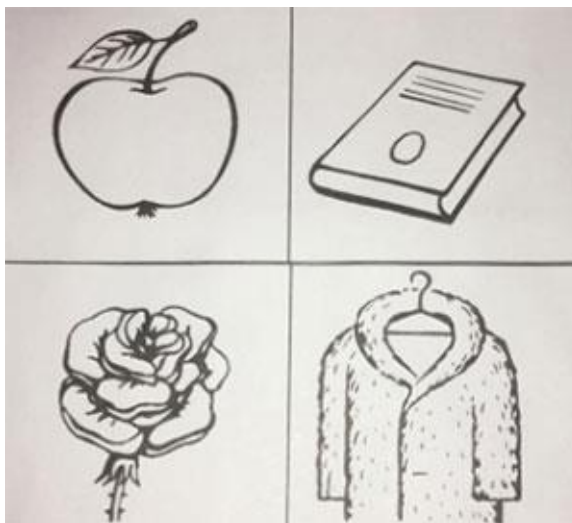

An extra fur coat, because a rose, an apple and a book are objects, when a rose is a natural plant. An apple is also natural. A book is made of paper. Paper is made of wood, and wood is also natural.

Task # 45. Check out the results of the “Exclusion of Objects” technique Identify the main pathopsychological symptoms of impaired thinking. Suggest the leading pathopsychological syndrome and *what diseases can it occur with?*



The extra one is the thimble. Because we hold the scissors with several fingers. We put the spool, tube and thimble on one finger.

Task # 46. Review the results of the "Exclusion of Objects" technique. Determine the main pathopsychological symptoms of impaired thinking. Suggest the leading pathopsychological syndrome and justify the answer.



The only thing that's extra is an umbrella, but the military has everything else.

Task # 47. Check out the results of the "Exclusion of Objects" technique Identify the main pathopsychological symptoms of impaired thinking. Suggest the leading pathopsychological syndrome and *what diseases can it occur with?*

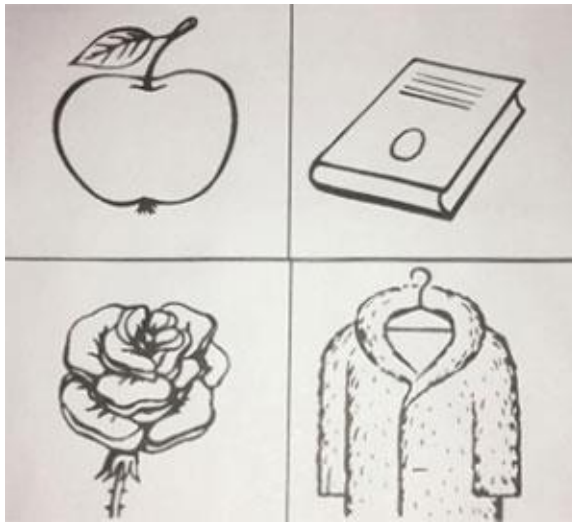

The extra thing is an apple. I have a book, a rose, and a fur coat at home in winter, but apples are bad in winter. That's why I don't buy them.

Task # 48. Check out the results of the “Exclusion of Objects” technique Identify the main pathopsychological symptoms of impaired thinking. Suggest the leading pathopsychological syndrome and *what diseases can it occur with?*

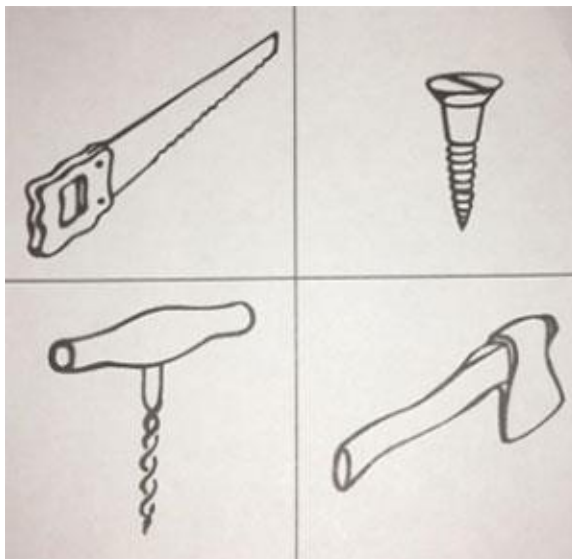

The axe is superfluous because it is used to hit, while the others are simply moved from side to side.

Task # 49. Check out the results of the “Exclusion of Objects” technique Identify the main pathopsychological symptoms of impaired thinking. Suggest the leading pathopsychological syndrome and *what diseases can it occur with?*

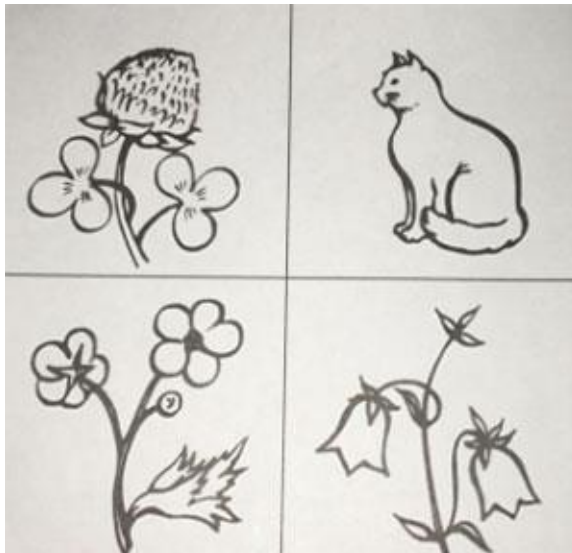

The cat is superfluous. She has no business being near flowers. Mine always eats all the flowers!

Task # 50. Check out the results of the “Exclusion of Objects” technique Identify the main pathopsychological symptoms of impaired thinking. Suggest the leading pathopsychological syndrome and *what diseases can it occur with?*

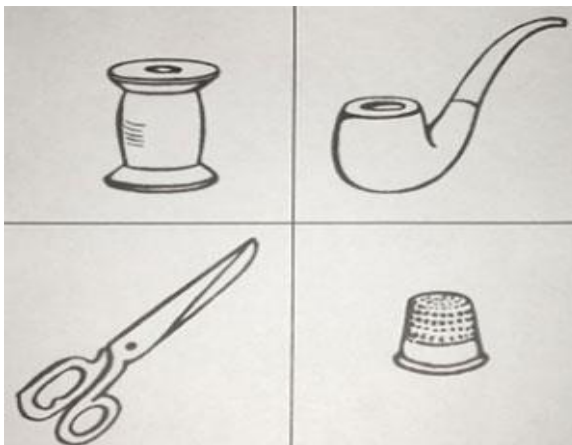

The pipe is superfluous here. That's obvious! The pipe is smoked, and the rest is for threads. To cut them and wind them. Well, a thimble is also used to push the thread through.

Заведующий кафедры, к.м.н., доцент

Н.В. Хмара